

Proposed Parking

For

Paterson Valley Community Preschool

Lot 77, Webbers Creek Road
Paterson, NSW 2421 (DP823698)

Drawing Schedule

Sheet No.	Sheet Title	Current Revision
A00.01	Cover Sheet	2
A01.01	Existing & Demolition Site Plan	2
A01.02	Proposed Site / Earthworks Plan / Sediment Control	2
A01.03	Proposed Concept Stormwater Drainage Plan	2
A01.04	Proposed Driveway Profile	2

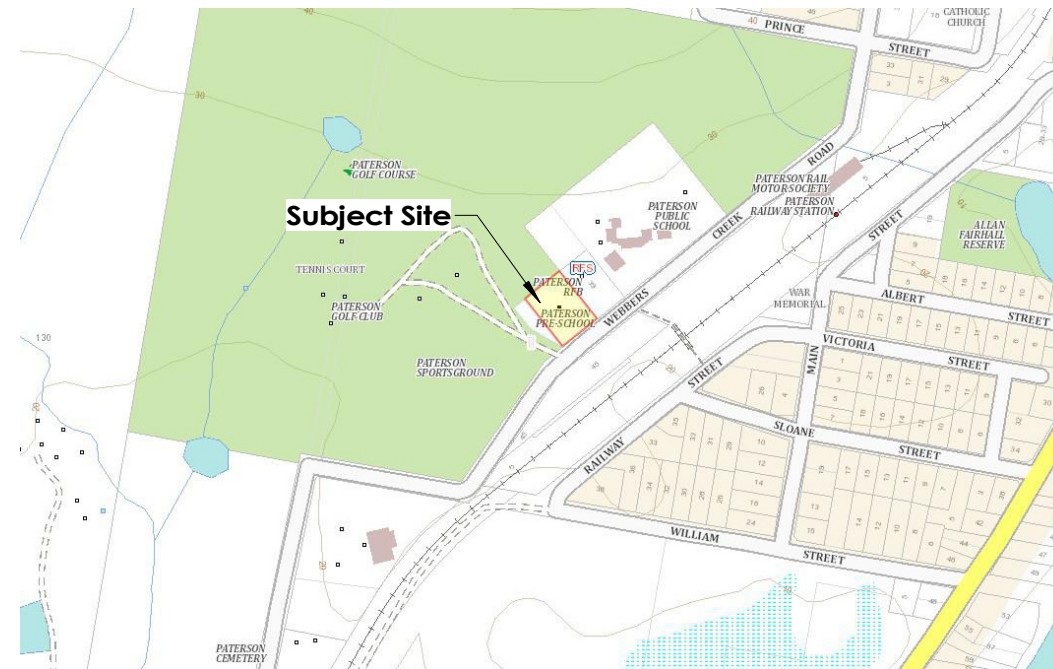

Locality Plan

(Source: Six Maps Website)

NOT FOR CONSTRUCTION



Ph: 0402 613 985

E: info@amsdesigndrafting.com.au

AMS Design & Drafting Pty Ltd

ABN: 46 652 427 891

www.amsdesigndrafting.com.au

www.facebook.com/amsdesigndrafting

Glebe Arcade, U1, 479-489 High Street, Maitland, NSW 2320



These plans are subject to copyright and must not be reproduced without permission

Member of BDAA: 6793-21

Accreditation #: 6895

No.	Date	Description	Issued By
2	02.12.24	Amendments to the driveway as per DSC Engineers comments	RK
1	16.09.24	Issued for DA	MR

client :
Paterson Valley Community Preschool

project :
**Lot 77, Webbers Creek Road
Paterson, NSW 2421 (DP823698)**

drawn by :	RL
checked by :	AS
date :	16.09.24
sheet title :	Cover Sheet

job no :	AMS-24-064
sheet no :	A00.01
scale :	on A3

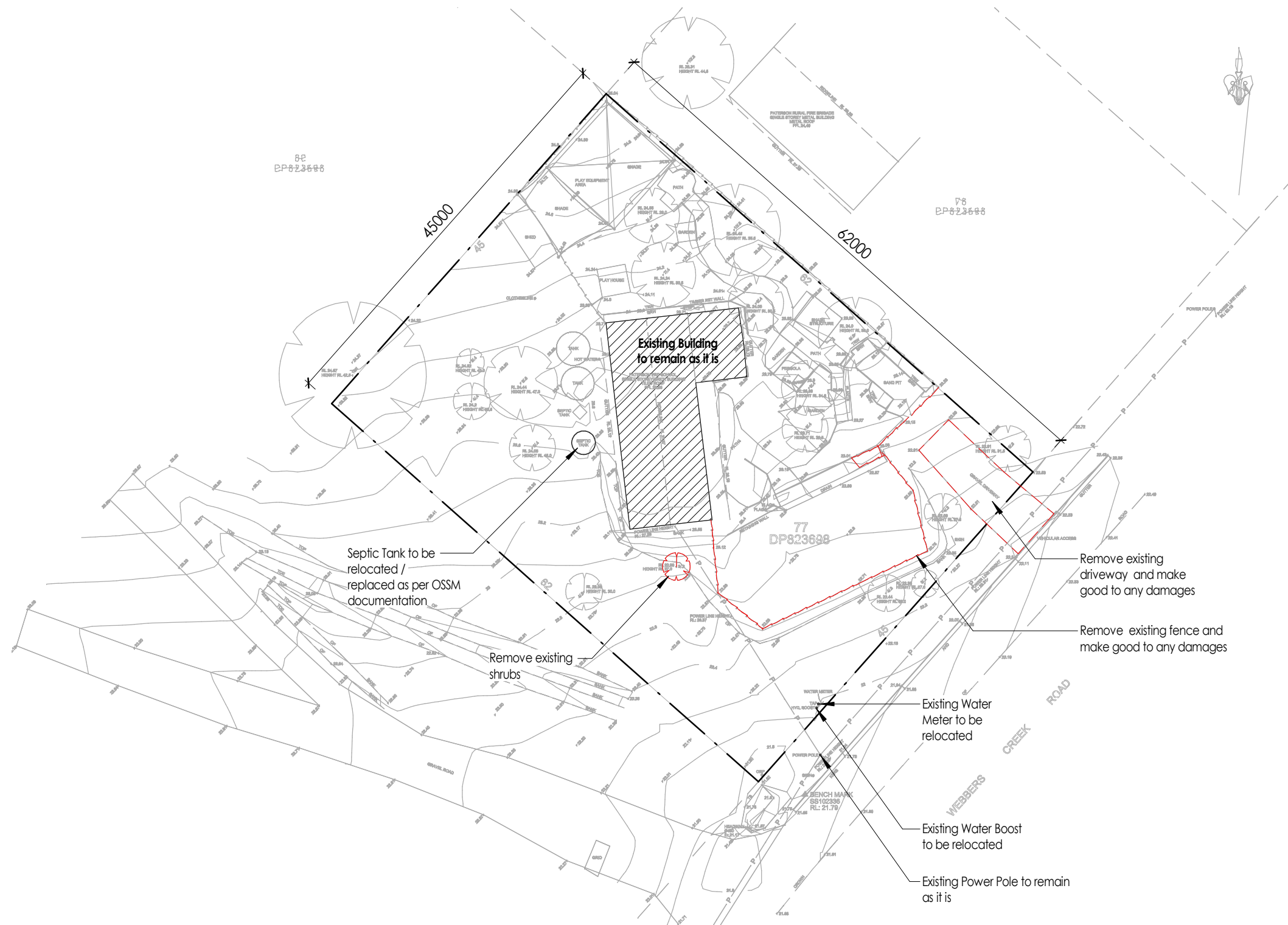

1 Existing & Demolition Site Plan

Scale : 1 : 500

NOT FOR CONSTRUCTION



Confirm excavation level
with Engineering drawings

DRIVEWAY NOTES

Driveway to comply and will be
constructed in accordance with
AS2890.1:2004 - Parking Facilities,
Part 1 : Off-street car parking

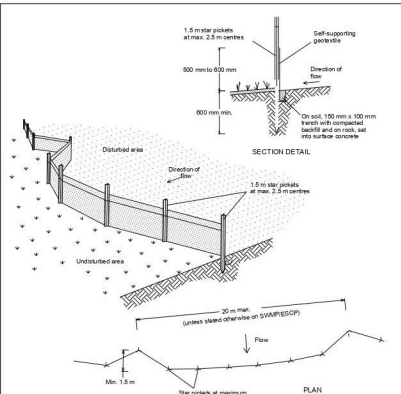

- Construction Notes**
- Construct sediment fences as close as possible to being parallel to the contours of the site, but with small returns as shown in the drawing to limit the catchment area of any one section. The catchment area should be small enough to limit water flow if concentrated at one point to 50 litres per second in the design storm event, usually the 10-year event.
 - Cut a 150-mm deep trench along the upslope line of the fence for the bottom of the fabric to be entrenched.
 - Drive 1.5 metre long star pickets into ground at 2.5 metre intervals (max) at the downslope edge of the trench. Ensure any star pickets are fitted with safety caps.
 - Fix self-supporting geotextile to the upslope side of the posts ensuring it goes to the base of the trench. Fix the geotextile with wire ties or as recommended by the manufacturer. Only use geotextile specifically produced for sediment fencing. The use of shade cloth for this purpose is not satisfactory.
 - Join sections of fabric at a support post with a 150-mm overlap.
 - Backfill the trench over the base of the fabric and compact it thoroughly over the geotextile.

SEDIMENT FENCE SD 6-8

SEDIMENTATION AND EROSION CONTROL NOTES:

- ALL EROSION AND SEDIMENT CONTROL MEASURES TO BE INSTALLED PRIOR TO SITE DISTURBANCE. ADDITIONAL BARRIERS MAYBE REQUIRED TO THOSE SHOWN ON THE DRAWINGS.
- ALL SILT BARRIERS SHALL BE REGULARLY INSPECTED & CLEANED OF SILT TO ENSURE CONTINUED OPERATION. ANY SILT BARRIERS THAT ALLOW SILT TO PASS ARE TO BE REPLACED. SILT STOP BARRIERS SHALL BE PROVIDED AROUND ALL STOCKPILES.
- TOPSOIL FROM ALL AREAS THAT WILL BE DISTURBED TO BE STRIPPED AND STOCKPILED AT THE NOMINATED SITE.
- ALL SEDIMENTATION & EROSION CONTROL MEASURES ARE TO STRICTLY COMPLY WITH THE GUIDELINES DETAILED IN THE DEPARTMENT OF HOUSING PUBLICATION, "MANAGING URBAN STORMWATER - SOILS AND CONSTRUCTION", 4TH EDITION.
- NO STOCKPILING OF MATERIALS IS PERMITTED ON THE VERGE BETWEEN KERB & PROPERTY BOUNDARY.
- NO VEHICLE CROSSING OR STOCKPILING OF MATERIAL ON VEGETATION BUFFER.
- ROOF DRAINAGE IS TO BE CONNECTED TO THE STORMWATER SYSTEM AS SOON AS PRACTICABLE.
- DEPRESSIONS LEFT IN THE FOOTPATH BY HEAVY TRUCKS ARE TO BE FILLED AS SOON AS POSSIBLE.
- ONLY ONE EXIT POINT SHOULD BE USED & SHOULD BE CONSTRUCTED SO AS TO PREVENT SOIL REACHING THE ROAD & TO STOP BOGGING.

DUST, NOISE & VIBRATION CONTROL

- SILENCERS ON PNEUMATIC TOOLS; MOBILE AIR COMPRESSORS; GRINDING EQUIPMENT & MECHANICAL PLANT SILENCING USING CURRENT TECHNOLOGY.
- VEHICULAR MOVEMENTS TO BE LIMITED TO NORMAL WORKING HOURS. PLANT AND MACHINERY TO BE REGULARLY SERVICED AND MAINTAINED.
- ALL VEHICLES, PLANTS AND MACHINERY TO BE FITTED WITH APPROPRIATE EMISSION CONTROL EQUIPMENT.
- SITE TO BE WATERED DOWN AFTER PROLONGED DRY DAYS OR ON WINDY DAYS; CONCRETE OR BRICK CUTTING ON SITE TO BE WATERED DOWN OR VACUUMING.

TREE PROTECTION

- ALL TREES WITHIN 5 METRES OF THE PROPOSED DEVELOPMENT AREA SHALL BE PROTECTED BY MEANS OF GENERAL PROTECTIVE FENCING BY FENCING AROUND GROUPS OF TREES OR BY INDIVIDUAL TREE GUARDS. ALL PROTECTIVE TREE FENCING IS TO BE TO THE SATISFACTION OF COUNCIL.

NOT FOR CONSTRUCTION

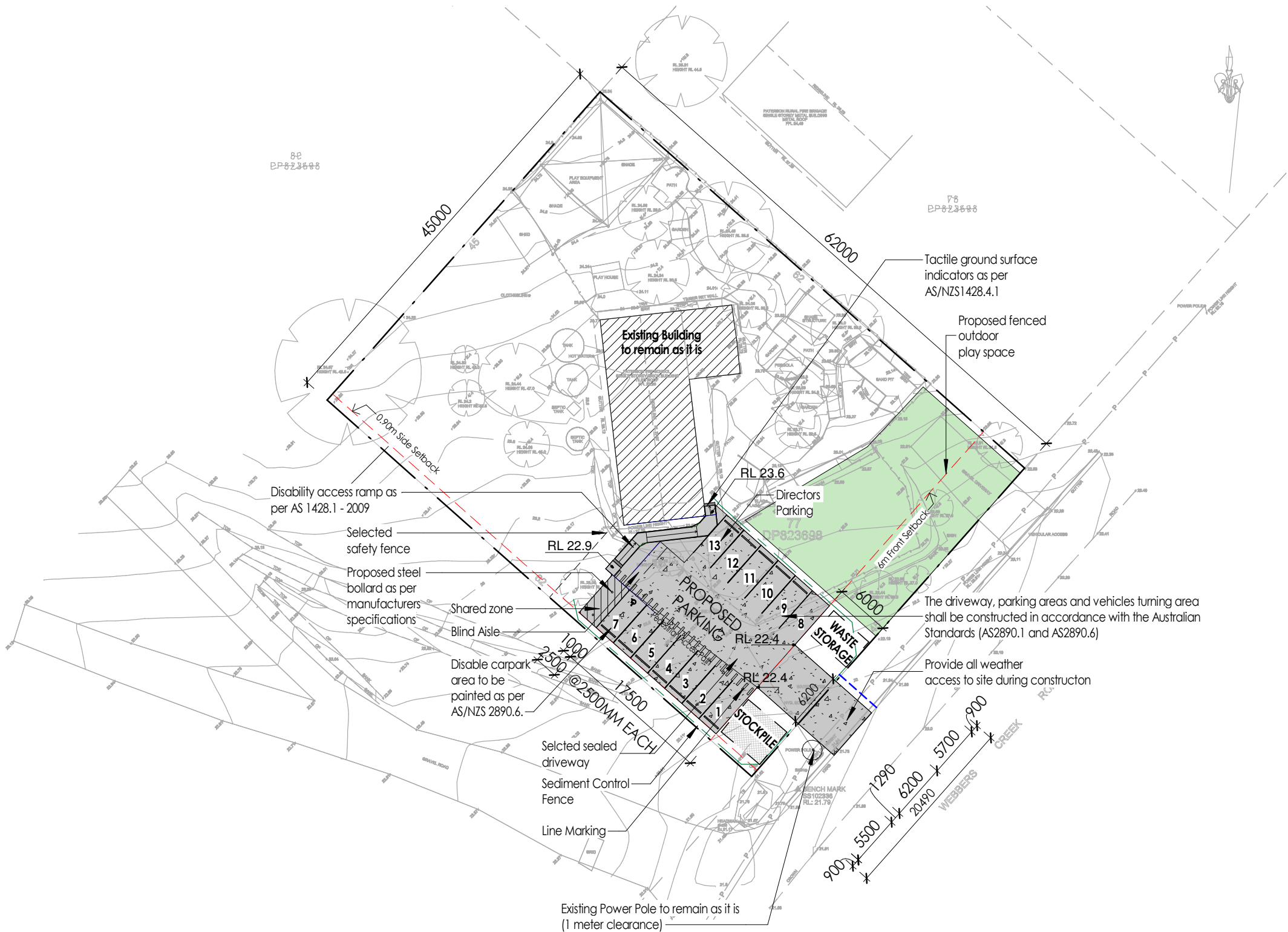

1

Proposed Site / Earthworks Plan / Sediment Control

Scale : 1 : 500



Ph: 0402 613 985

E: info@amsdesigndrafting.com.au

AMS Design & Drafting Pty Ltd

ABN: 46 652 427 891

www.amsdesigndrafting.com.au

www.facebook.com/amsdesigndrafting

Glebe Arcade, U1, 479-489 High Street, Maitland, NSW 2320

These plans are subject to copyright and
must not be reproduced without permission



Member of BDAAC: 6793-21

Accreditation #: 6895

ACCREDITED
BUILDING DESIGNER

No.	Date	Description	Issued By
2	02.12.24	Amendments to the driveway as per DSC Engineers comments	RK
1	16.09.24	Issued for DA	MR

client :
Paterson Valley Community Preschool

project :
Lot 77, Webbers Creek Road
Paterson, NSW 2421 (DP823698)

drawn by :

RL

checked by :

AS

date :

16.09.24

sheet title :

Proposed Site / Earthworks
Plan / Sediment Control

job no :

AMS-24-064

sheet no :

A01.02

scale :

As indicated on A3

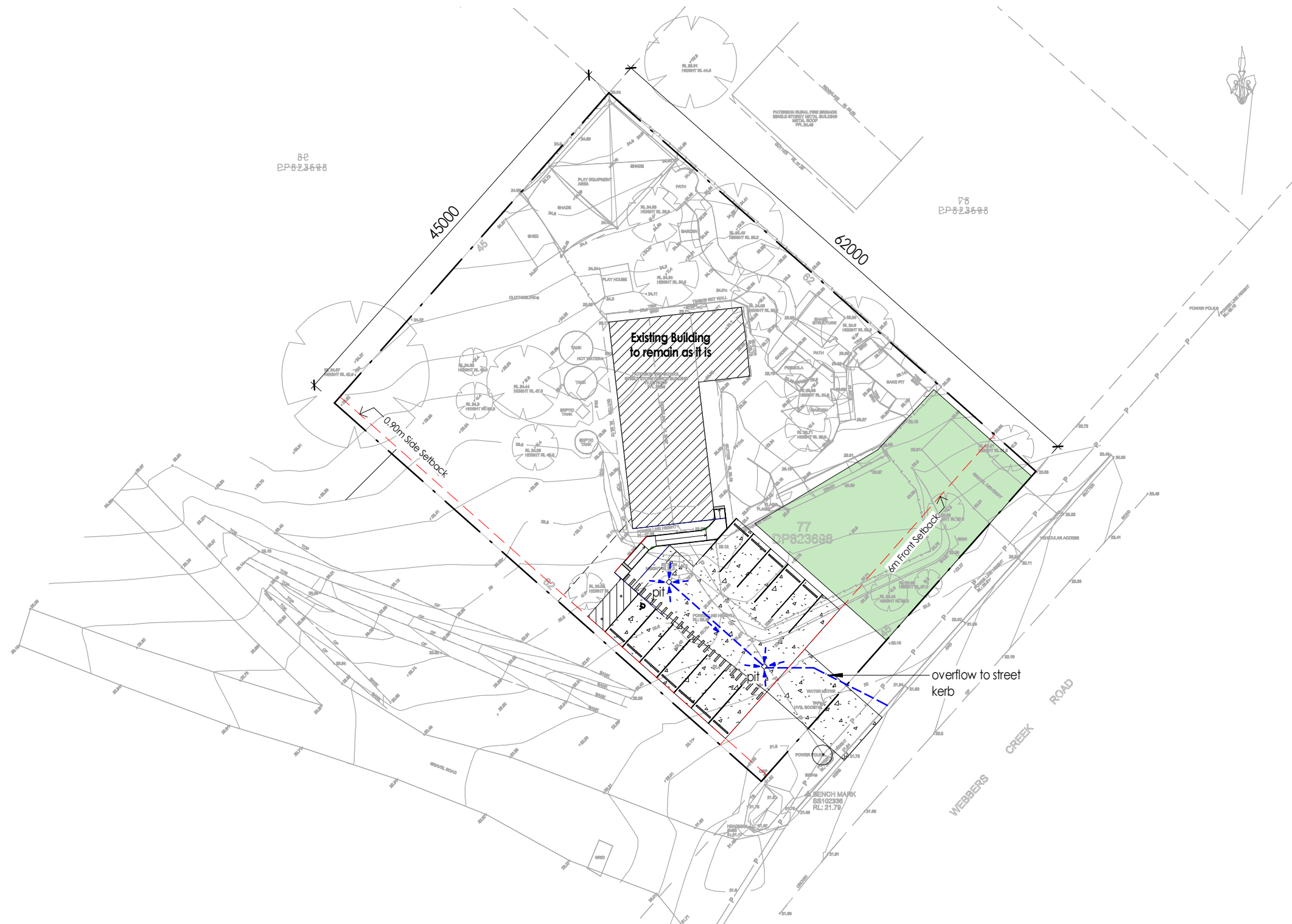

1 Concept Stormwater Drainage Plan

Scale : 1 : 500

- CONTRACTOR TO CONFIRM INVERT LEVEL OF SPECIFIED OUTLET PRIOR TO WORK WITH ANY DISCREPANCY REPORTED TO THE DESIGNER.
- ALL STORMWATER DRAINAGE TO BE INSTALLED IN ACCORDANCE WITH AS3500.3.
- ALL EXISTING DRAINAGE WITHIN THE SITE IS TO BE FLUSHED (IF REQUIRED) AND CONNECTED TO THE NEW DRAINAGE NETWORK.
- STORMWATER PIPES TO BE LAID WITH 1% (MIN.) GRADE UNLESS NOTED OTHERWISE.
- RETAINING WALL AND OTHER SUBSOIL DRAINAGE LINES ARE TO DRAIN TO CLOSEST DOWNSTREAM STORMWATER PIT
- HARVESTED RAINWATER IS TO BE REUSED FOR TOILET FLUSHING LAUNDRY AND OUTDOOR TAP.
- ACTUAL LAYOUT OF DOWNPIPES & MINOR DRAINAGE TO BE CONFIRMED BY THE PLUMBER. ALL WORKS ARE TO BE IN ACCORDANCE WITH THE REQUIREMENTS OF THE NCC & AS3500
- DRAINAGE DIAGRAMS : STORMWATER IS INDICATIVE ONLY AND MAY VARY DUE TO THE REQUIREMENTS OF AUTHORITIES AND / OR PARTICULAR SITE CONDITIONS
- CONNECT HOUSEWASTES AND SEWERAGE POINTS TO SEPTIC DRAINAGE SYSTEM AS REQUIRED BY COUNCIL REGULATIONS.

NOT FOR CONSTRUCTION

